

Capacitor contactor, AC-6, 50 kVA<sub>r</sub> / 400 V, 400 V, 50 Hz, 3-pole,  
Size S3 !!! Phased-out product !!! Successor is SIRIUS 3RT2



## General technical data

<b>Protection class IP</b>	IP00
<ul style="list-style-type: none"> <li>• on the front</li> <li>• of the terminal</li> </ul>	IP00; IP20 on the front with cover / box terminal IP00
<b>Reference code acc. to DIN EN 81346-2</b>	Q

## Ambient conditions

<b>Ambient temperature</b>	
<ul style="list-style-type: none"> <li>• during operation</li> </ul>	-25 ... +60 °C

## Main circuit

<b>Number of NO contacts for main contacts</b>	3
<b>Number of NC contacts for main contacts</b>	0
<b>Operating current</b>	
<ul style="list-style-type: none"> <li>• at AC-1 at 400 V</li> <li>— rated value</li> </ul>	90 A

## Control circuit/ Control

<b>Type of voltage</b>	AC
<b>Control supply voltage at AC</b>	

• at 50 Hz rated value	400 ... 400 V
Supply voltage frequency for auxiliary and control current circuit rated value	50 ... 50 Hz

Auxiliary circuit	
Number of NC contacts for auxiliary contacts	0
Number of NO contacts for auxiliary contacts	1
Identification number and letter for switching elements	1

Installation/ mounting/ dimensions	
Mounting type	screw and snap-on mounting onto 35 mm standard mounting rail according to DIN EN 50022
• Side-by-side mounting	Yes
Height	167 mm
Width	70 mm
Depth	183 mm

Connections/ Terminals	
Type of electrical connection	
• for main current circuit	screw-type terminals
• for auxiliary and control current circuit	screw-type terminals

### Certificates/ approvals

General Product Approval	EMC	Functional Safety/Safety of Machinery
--------------------------	-----	---------------------------------------



[Type Examination Certificate](#)

Declaration of Conformity	Test Certificates	Marine / Shipping	other
---------------------------	-------------------	-------------------	-------



[Miscellaneous](#)

[Special Test Certificate](#)



[Confirmation](#)

other	Railway
<a href="#">Miscellaneous</a>	<a href="#">Special Test Certificate</a>

## Further information

### **Information- and Downloadcenter (Catalogs, Brochures,...)**

<https://www.siemens.com/ic10>

### **Industry Mall (Online ordering system)**

<https://mall.industry.siemens.com/mall/en/en/Catalog/product?mlfb=3RT1647-1AV01>

### **Cax online generator**

<http://support.automation.siemens.com/WW/CAXorder/default.aspx?lang=en&mlfb=3RT1647-1AV01>

### **Service&Support (Manuals, Certificates, Characteristics, FAQs,...)**

<https://support.industry.siemens.com/cs/ww/en/ps/3RT1647-1AV01>

### **Image database (product images, 2D dimension drawings, 3D models, device circuit diagrams, EPLAN macros, ...)**

[http://www.automation.siemens.com/bilddb/cax\\_de.aspx?mlfb=3RT1647-1AV01&lang=en](http://www.automation.siemens.com/bilddb/cax_de.aspx?mlfb=3RT1647-1AV01&lang=en)

### **Characteristic: Tripping characteristics, I<sup>2</sup>t, Let-through current**

<https://support.industry.siemens.com/cs/ww/en/ps/3RT1647-1AV01/char>

### **Further characteristics (e.g. electrical endurance, switching frequency)**

<http://www.automation.siemens.com/bilddb/index.aspx?view=Search&mlfb=3RT1647-1AV01&objecttype=14&gridview=view1>

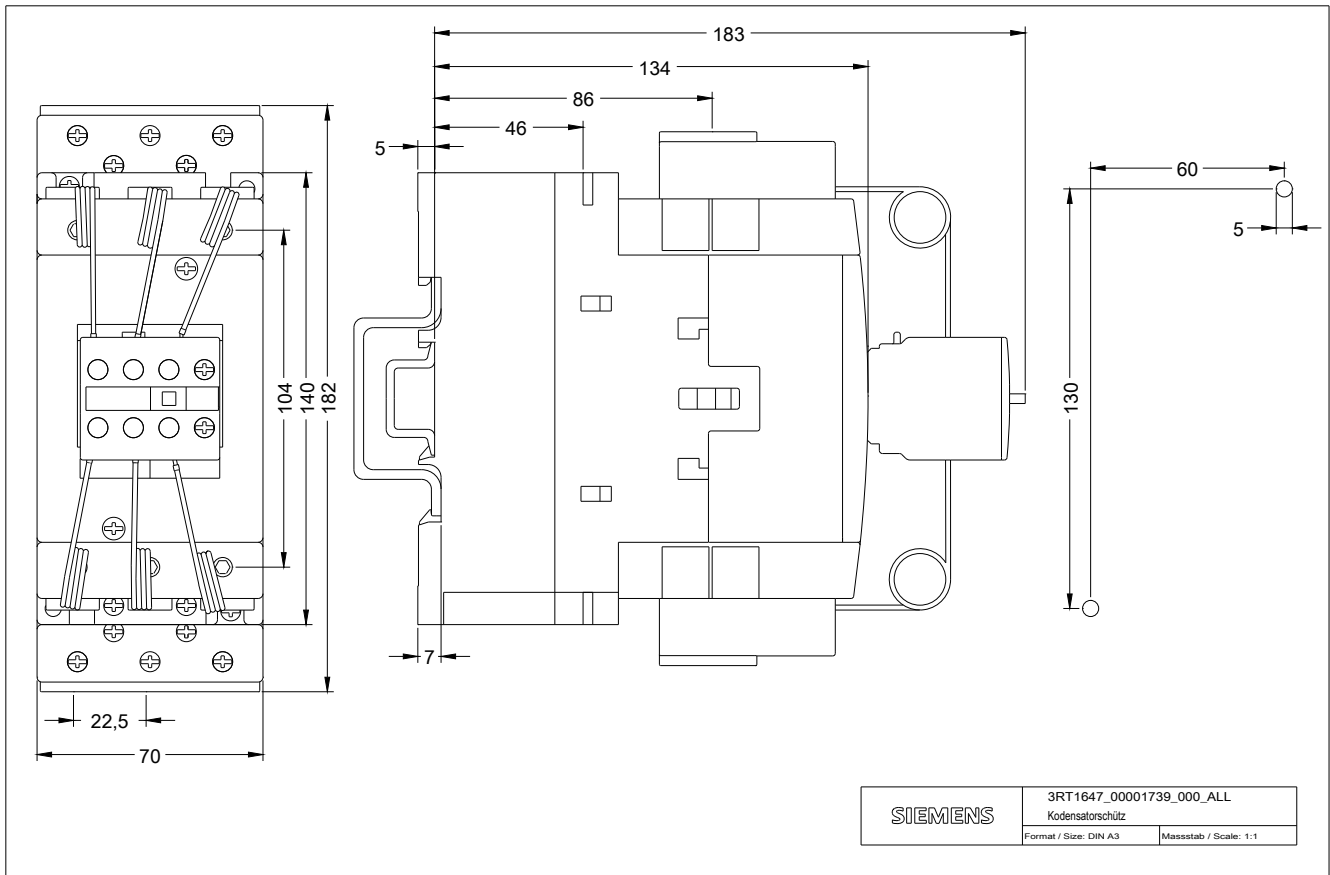

-Q

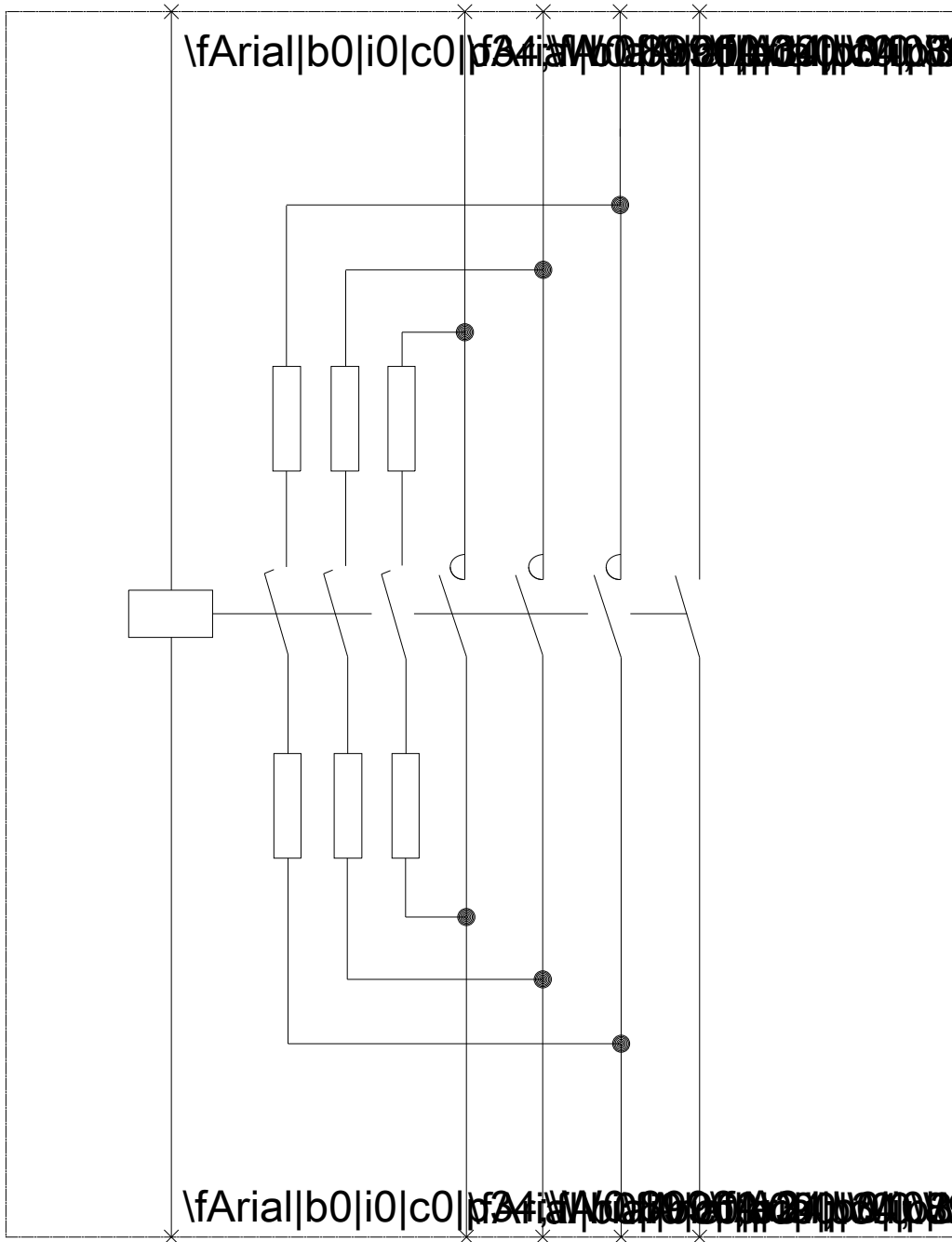

last modified:

02/07/2020